

SA FORMING

FA381VS-3



VS



FA481VS-3



VS



FA381VS-3

FA481VS-3

FA381VS-3

FA481VS-3

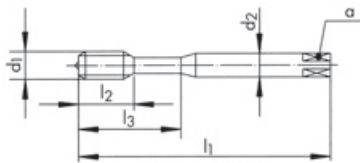

6HX

6HX

6GX

6GX

Ø d ₁ M	P mm	l ₁ mm	l ₂ mm	l ₃ mm	d ₂ mm	a mm	Tol. M
3	0.50	56	12.0	18	3.5	2.7	+/- 0.03
3.5	0.60	56	13.0	20	4.0	3.0	+/- 0.03
4	0.70	63	14.0	21	4.5	3.4	+/- 0.03
5	0.80	70	15.0	25	6.0	4.9	+/- 0.04
6	1.00	80	17.0	30	6.0	4.9	+/- 0.05
8	1.25	90	20.0	35	8.0	6.2	+/- 0.05
10	1.50	100	22.0	39	10.0	8.0	+/- 0.05
12	1.75	110	24.0	45	9.0	7.0	+/- 0.05
14	2.00	110	28.0	55	11.0	9.0	+/- 0.05
16	2.00	110	30.0	60	12.0	9.0	+/- 0.05

ID

0.25

40

ID

5.5

40

ID

2.5

2.1

ID

1.1

0.25

40

ID

5.5

40

ID

2.5

2.1

ID

1.2

0.25

40

ID

5.5

40

ID

2.5

2.1

ID

1.4

0.30

40

ID

7.0

40

ID

2.5

2.1

ID

1.5

0.30

40

ID

8.0

40

ID

2.5

2.1

SA FORMING

FA384VS-3



VS

21	22	23	24	41
51	61	63	71	

FA484VS-3



VS

21	22	23	24	41
51	61	63	71	

FA384VS-3

FA484VS-3

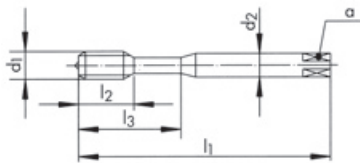

6HX

6HX

$\varnothing d_1$ M	P mm	l_1 mm	l_2 mm	l_3 mm	d_2 mm	α mm	$\rightarrow \leftarrow$	Tol.
5	0.80	70	15.0	25	6.0	4.9	4.65	+/- 0.03
6	1.00	80	17.0	30	6.0	4.9	5.55	+/- 0.05
8	1.25	90	20.0	35	8.0	6.2	7.40	+/- 0.05
10	1.50	100	22.0	39	10.0	8.0	9.30	+/- 0.05
12	1.75	110	24.0		9.0	7.0	11.20	+/- 0.05
14	2.00	110	28.0		11.0	9.0	13.10	+/- 0.05
16	2.00	110	30.0		12.0	9.0	15.10	+/- 0.05

ID

ID

155159

155160

155161

155162

155163

155164

155165

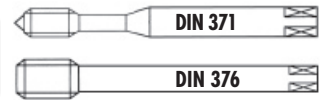

SP FORMING

FP381CN-3		CrN	63 72 73
FP481CN-3		CrN	63 72 73
FP381VS-3		VS	11 12 13 14 15 21 12
FP481VS-3		VS	11 12 13 14 15 21 12

FP381CN-3 FP481CN-3 FP381VS-3 FP481VS-3

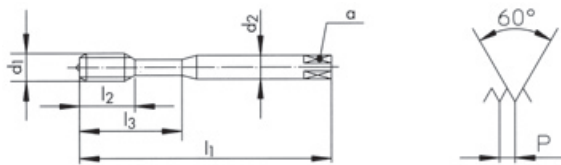

6HX **6HX** **6HX** **6HX**

∅ d ₁ MF	P mm	l ₁ mm	l ₂ mm	l ₃ mm	d ₂ mm	a mm		Tol.
4	0.50	63	14.0	21	4.5	3.4	3.80	+/- 0.03
5	0.50	70	15.0	25	6.0	4.9	4.80	+/- 0.03
6	0.50	80	17.0	30	6.0	4.9	5.80	+/- 0.03
6	0.75	80	17.0	30	6.0	4.9	5.65	+/- 0.03
8	0.75	90	20.0	35	8.0	6.2	7.65	+/- 0.05
8	1.00	90	20.0	35	8.0	6.2	7.55	+/- 0.05
10	1.00	100	22.0	39	10.0	8.0	9.55	+/- 0.05
12	1.00	100	19.0	39	9.0	7.0	11.55	+/- 0.05
14	1.50	100	24.0	39	11.0	9.0	13.30	+/- 0.05
16	1.50	100	26.0	39	12.0	9.0	15.30	+/- 0.05

ID ID ID ID

151126		151118	
151127		151119	
157163		157161	
151128		151120	
157164		157162	
151129		151121	
151130		151122	
	151131		151123
	151132		151124
	151133		151125

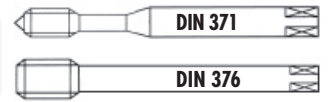

SA FORMING

FA381VS-3



VS



FA481VS-3



VS



FA381VS-3

FA481VS-3

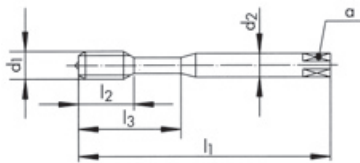

6HX

6HX

∅ d ₁ MF	P mm	l ₁ mm	l ₂ mm	l ₃ mm	d ₂ mm	α mm	Tol.	
4	0.50	63	14.0	21	4.5	3.4	3.80	+/- 0.03
5	0.50	70	15.0	25	6.0	4.9	4.80	+/- 0.03
6	0.50	80	17.0	30	6.0	4.9	5.80	+/- 0.03
6	0.75	80	17.0	30	6.0	4.9	5.65	+/- 0.03
8	0.75	90	20.0	35	8.0	6.2	7.65	+/- 0.05
8	1.00	90	20.0	35	8.0	6.2	7.55	+/- 0.05
10	1.00	100	22.0	39	10.0	8.0	9.55	+/- 0.05
12	1.00	100	19.0		9.0	7.0	11.55	+/- 0.05
14	1.50	100	24.0		11.0	9.0	13.30	+/- 0.05
16	1.50	100	26.0		12.0	9.0	15.30	+/- 0.05

ID

ID

151110

151111

157159

151112

157160

151113

151114

151115

151116

151117

FS, FP, FA FORMING

FS380VS-3  **VS**

11	12	13	14
21	22	23	41
51	61	63	71
72	73		

FP381VS-3  **VS**

11	12	13	14	15
21	22			

FA381VS-3  **VS**

21	22	23	24	41
51	61	63	71	

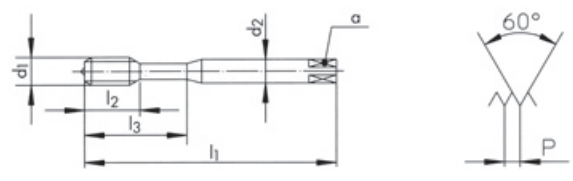

FS380VS-3		FP381VS-3	FA381VS-3
-----------	--	-----------	-----------



2BX **2BX** **2BX**

Ø" d ₁ UNC	P TPI	d ₁ mm	l ₁ mm	l ₂ mm	l ₃ mm	d ₂ mm	α mm		Tol.
2	56	2.18	45	9.0		2.8	2.1	1.95	+/- 0.02
4	40	2.85	56	12.0	18.0	3.5	2.7	2.55	+/- 0.03
6	32	3.51	56	13.0	20.0	4.0	3.0	3.15	+/- 0.03
8	32	4.17	63	14.0	21.0	4.5	3.4	3.80	+/- 0.03
10	24	4.83	70	15.0	25.0	6.0	4.9	4.35	+/- 0.03
1/4	20	6.35	80	17.0	30.0	7.0	5.5	5.75	+/- 0.03
5/16	18	7.94	90	20.0	35.0	8.0	6.2	7.30	+/- 0.03

ID	ID	ID
157285		
157287		
	157289	157310
	157290	157311
	157291	157312
	157292	157313
	157293	157314

SP, SA FORMING

FP381VS-3



VS



FA381VS-3



VS



FP381VS-3

FA381VS-3

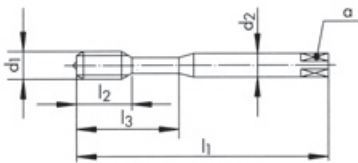

2BX

2BX

\varnothing d ₁ UNF	P TPI	d ₁ mm	l ₁ mm	l ₂ mm	l ₃ mm	d ₂ mm	α mm	Tol.
6	40	3.51	56	13.0	20.0	4.0	3.0	3.20 +/- 0.03
10	32	4.83	70	15.0	25.0	6.0	4.9	4.45 +/- 0.03
1/4	28	6.35	80	17.0	30.0	7.0	5.5	5.95 +/- 0.03
5/16	24	7.94	90	20.0	35.0	8.0	6.2	7.45 +/- 0.03

ID

ID

157295
157297
157298
157299

157316
157318
157319
157320